

United States Department of the Interior
Heritage Conservation and Recreation Service

National Register of Historic Places
Inventory—Nomination Form

For HCRS use only

received

date entered

See instructions in *How to Complete National Register Forms*
Type all entries—complete applicable sections

1. Name

historic University of Puerto Rico Tower and Quadrangle (including some adjacent buildings)

and/or common Same

2. Location

street & number Ponce de León Avenue _____ not for publication

city, town Río Piedras _____ vicinity of _____ congressional district

state Puerto Rico code 72 county Río Piedras, San Juan code 0930

3. Classification

Category	Ownership	Status	Present Use	
<input type="checkbox"/> district	<input checked="" type="checkbox"/> public	<input checked="" type="checkbox"/> occupied	<input type="checkbox"/> agriculture	<input type="checkbox"/> museum
<input checked="" type="checkbox"/> building(s)	<input type="checkbox"/> private	<input type="checkbox"/> unoccupied	<input type="checkbox"/> commercial	<input checked="" type="checkbox"/> park
<input type="checkbox"/> structure	<input type="checkbox"/> both	<input type="checkbox"/> work in progress	<input checked="" type="checkbox"/> educational	<input type="checkbox"/> private residence
<input type="checkbox"/> site	Public Acquisition	Accessible	<input checked="" type="checkbox"/> entertainment	<input type="checkbox"/> religious
<input type="checkbox"/> object	<input type="checkbox"/> in process	<input type="checkbox"/> yes: restricted	<input checked="" type="checkbox"/> government	<input type="checkbox"/> scientific
	<input type="checkbox"/> being considered	<input checked="" type="checkbox"/> yes: unrestricted	<input type="checkbox"/> industrial	<input type="checkbox"/> transportation
		<input type="checkbox"/> no	<input type="checkbox"/> military	<input type="checkbox"/> other:

4. Owner of Property

name University of Puerto Rico

street & number Ponce de León Avenue

city, town Río Piedras _____ vicinity of _____ state Puerto Rico

5. Location of Legal Description

courthouse, registry of deeds, etc. President's Office and Planning and Development Office

street & number Central Administration and Río Piedras' Property Registry

city, town Río Piedras _____ state Puerto Rico

6. Representation in Existing Surveys

title Inventario de Monumentos Históricos has this property been determined eligible? yes no

date 1977 _____ federal _____ state _____ county _____ local

depository for survey records Insitute of Puerto Rican Culture

city, town San Juan _____ state Puerto Rico 00905

7. Description

Condition

excellent
 good
 fair

deteriorated
 ruins
 unexposed

Check one

unaltered
 altered

Check one

original site
 moved date _____

Describe the present and original (if known) physical appearance

(See annex for written description and photographic illustrations)
(See Enclosure No. 1)

The University of Puerto Rico Tower and Quadrangle Complex, constructed during the years 1935 to 1944, comprises the main entrance to the Río Piedras Campus. It is the core and symbol of the Campus and of the University system as a whole. Its architectural style can be described as a modified plateresque. Designed by the well known Puerto Rican architect Rafael Carmoega, and assisted by other local architects, the buildings and open spaces that comprise the Quadrangle and the imposing Tower, (which at the time it was constructed was the tallest structure in the city of Río Piedras), are, even today, an urban and educational landmark.

8. Significance

Period	Areas of Significance—Check and justify below			
<input type="checkbox"/> prehistoric	<input type="checkbox"/> archeology-prehistoric	<input checked="" type="checkbox"/> community planning	<input type="checkbox"/> landscape architecture	<input type="checkbox"/> religion
<input type="checkbox"/> 1400–1499	<input type="checkbox"/> archeology-historic	<input type="checkbox"/> conservation	<input type="checkbox"/> law	<input type="checkbox"/> science
<input type="checkbox"/> 1500–1599	<input type="checkbox"/> agriculture	<input type="checkbox"/> economics	<input type="checkbox"/> literature	<input type="checkbox"/> sculpture
<input type="checkbox"/> 1600–1699	<input checked="" type="checkbox"/> architecture	<input checked="" type="checkbox"/> education	<input type="checkbox"/> military	<input type="checkbox"/> social/ humanitarian
<input type="checkbox"/> 1700–1799	<input type="checkbox"/> art	<input type="checkbox"/> engineering	<input type="checkbox"/> music	<input type="checkbox"/> theater
<input type="checkbox"/> 1800–1899	<input type="checkbox"/> commerce	<input type="checkbox"/> exploration/settlement	<input type="checkbox"/> philosophy	<input type="checkbox"/> transportation
<input checked="" type="checkbox"/> 1900–	<input type="checkbox"/> communications	<input type="checkbox"/> industry	<input type="checkbox"/> politics/government	<input type="checkbox"/> other (specify)
		<input type="checkbox"/> invention		

Specific dates 1935 **Builder/Architect** Arch. Rafael Carmoega

Statement of Significance (in one paragraph)

Since it was built in the thirties, the Quadrangle, with its main feature, the tower, has been a landmark in Río Piedras and the whole of the San Juan metropolitan area. From an architectural and aesthetic point of view, it is a unique complex in Puerto Rico--it has no parallel in style or magnitude and would be worth conserving even if these were its only values. It embodies Hispanic tradition, the principal root of Puerto Rican culture; it is a symbol of the permanent presence of that tradition; and it functions at the same time as a home for unceasing efforts devoted to preserve and extend it. It is the place where higher learning grew to maturity in Puerto Rico, and where indeed it is still epitomized: to speak of "the University" without further specification is to refer to the Río Piedras campus and particularly to its nucleus, the cloisters and buildings that comprise the Quadrangle and contain the Offices of the Chancellor and the central administration of the Campus, the theatre where the Casals' Festival used to take place, and the College of Humanities.

As to its historical significance, it must be noted that during the forties and the fifties, the period of Puerto Rico's modernization and its political, social and economic development and coming of age, all public issues were debated in these very halls. Everyone who mattered politically or intellectually was either from the University or had dealings with it. The University was the source of ideas, initiative and plans. That has been its glory. As the state university, it has grown enormously

**United States Department of the Interior
Heritage Conservation and Recreation Service**

**National Register of Historic Places
Inventory—Nomination Form**

For HCRS use only

received

date entered

Continuation sheet

Item number 8

Page 2

and trained the faculty and staffs of the other, private universities that have appeared and now share in the cultural leadership this campus once enjoyed alone. This particular place merits preservation as a heritage for future generations, for here a significant portion of Puerto Rico's history has been made and its modern leadership has been trained. The University Quadrangle is the symbol of an era.

I N D E X

	PAGES
HISTORICAL BACKGROUND	1 - 4
INVENTORY OF BUILDINGS	6
PHOTOGRAPHS	8

TOWER AND QUADRANGLE COMPLEX, CENTRAL CAMPUS,
UNIVERSITY OF PUERTO RICO, RIO PIEDRAS, PUERTO RICO
(1935 -)

By Dr. Eugene E. Crommett
Professor of Architecture, UPR

HISTORICAL BACKGROUND:

Founded in 1903 with 90 students and 12 professors, the University of Puerto Rico is today (1982) an Island-wide university system with a student population in the tens of thousands. What is at present its main campus in Río Piedras consists of 128 buildings occupying 280 acres of park-like ground on the edge of Metropolitan San Juan. The Tower and Quadrangle Complex, dating from 1935, comprises the main and "official" entrance to the campus, the Tower, administrative offices, classroom buildings, and the University Theater.

Although the campus has long since expanded well beyond the limits of its original buildings, the Complex with its urban landmark tower, distinctive appearance and organization, and integration of buildings with the natural landscape, remains the gateway, core and symbol of the entire campus, indeed of the university system as a whole.

THE ARCHITECTS:

The architect for the Complex was the well known Rafael Carmoega who designated several other architects to assist him: William Shimmelpfening, a German-American who planned the Tower, and Puerto

Rican architects Francisco Gardón who designed the Theater, Rafael Hernández, Eloy Plard, and Raúl Reichard. Until his untimely death, the architect Pedro de Castro was contractor for the project. This group was responsible for the design of the project in all its details, including the structural and other building systems.

URBAN SETTING:

The Tower and Quadrangle Complex acts as a transitional element between the urban area surrounding it and the park-like environment of the campus. Three gates along Ponce de León Avenue open onto a large, well landscaped fore area: the center entrance, for pedestrians, is on the central axis of the whole Complex which moves up a palm-lined walkway, through the center of the Tower and out into the inner cloister area, to end at the entrance of the University Theater (a later building unfortunately interrupts this axis); the two outer vehicle entrances are at the ends of a loop road which approaches the Tower at its center, where pedestrians meet to enter the Complex. The distinctive bell-observation Tower has long been a focal and orientation point for the university and the surrounding urban area.

ARCHITECTURAL ORGANIZATION OF THE COMPLEX:

The buildings of the Complex are arranged to accommodate three organizational concepts: a main symmetrical axis from the main entrance to the Theater; a traditional cloister or inner quadrangle around which the buildings are sited and onto which they open; and a series of arcades which offer sheltered communications and exits at the corners of the Quadrangle.

The inner garden plaza facilitates diagonal pedestrian traffic through the Quadrangle, and serves as an open but tree-shaded place for rest and conversation.

NOTES ON MATERIALS AND CONSTRUCTION:

Except, perhaps, for the Tower and the University Theater, the materials and methods of construction of the buildings of the Complex are conventional, but they are well executed. Moreover, their consistency of use and quality gives additional unity to the Quadrangle.

The buildings are two and three stories in height and rectangular in shape. Class and other rooms are generally arranged along single loaded corridors (arcades) for the most part, facilitating cross ventilation, although the registrar's office building has double loaded corridors. The rectangular units are connected into H-forms, keeping the plan open, well ventilated, and affording contact between the interiors and the landscaped grounds outside. The general layout of the buildings is an early and viable solution for solar design in the humid tropics.

The materials of construction are masonry concrete, stucco, wood, and tiles. Sloping roof sections carry Spanish red clay tiles, giving drainage, character and continuity, especially to the arcades. The Tower entrance, with its high vaulted ceiling and inner balcony under it, combines structural wood construction with concrete masonry. The University Theater (long known as the home of the Casals Festival) employs modern structural techniques with its long trusses over the audience, and its mechanical and electrical systems, and has seats for nearly 2500. Wall surfaces are smooth

(except for the concentrations of decorative elements) and finished in plaster and paint.

STYLE AND DECORATION :

The Tower and Quadrangle Complex derives much of its importance from its overall organizational themes and unity, as well as its strong character as an urban landmark. But it is also significant as an example of Puerto Rican architects searching for and creating an appropriate symbol for a modern university in Puerto Rico located at the meeting place of North and South America, and of past and present cultures. The contrasts between simplicity and complexity and the historical allusions to the Spanish Colonial Renaissance or Baroque, that is the Plateresque Style, seemed appropriate to them.

Stylistically, the Complex is an adapted, modified Plateresque, say Neo-Plateresque, which depends heavily upon sometimes dramatic contrasts between simple stark surfaces and elaborated concentrations of ornament at fenestration elements. Thus in the Complex's arcades there are twisted columns capped by Corinthian capitals, and concentrations of ornaments reminiscent of Spanish Baroque altar pieces appear in the interior of the University Theater. Heraldic shields, figures, faces, foliage, pilasters, volutes, and cornices are brought together and brightly colored in concentrations that mark principal entrances, notably that of the Tower.

The main portal of the Tower - and the Quadrangle - provides the best example of this Neo-Plateresque ornamentation, and as well of

the symbolic intent of the project's designers. That the University of Puerto Rico is firmly planted in the soil once occupied by the Conquistadores is evident from the portal's Plateresque (Plateresco, Sp.) roots. But more significantly, there are three large heraldic shields directly over and forming the main motif of the decorative concentration at this entrance. At the center, significantly, the shield depicts the precepts of history, of knowledge and of work. The shield at the left, representing the Americas of the South, is of the University of San Marcos in Perú, and that at the right, representing the Americas of the North, is of the University of Harvard. Similarly, embedded in the floor of the Tower entrance under the vaulted ceiling is a circle of plaque-shields representing the countries of North, Central and South America.

INVENTORY OF BUILDINGS

I N V E N T O R Y

QUADRANGLE:

Name of the buildings that compose the Quadrangle and other contiguous buildings .

1. The Tower - (1937 (1st floor: Román Baldorioty de Castro)
(2nd floor: Franklin Delano Roosevelt)
2. Antonio S. Pedreira (1937)
3. Sebastián González García (1944)
4. Luis Palés Matos and Julia de Burgos Amphitheater (1953 both)
5. Agustín Stahl (contiguous to the Quadrangle) (1931-46)
6. Julio García Díaz (contiguous to the Quadrangle) (1937)
7. Theater (no name) (1935-40)
8. Eugenio Marfa de Hostos (1935-40)
9. Registrar's Office (1935)
10. Felipe Janer (1927)
11. Janer B Annex (Home Economics) (1936)

Source: Juan José González Correa
Central Archives' Director

PHOTOGRAPHS

BIBLIOGRAFIA

A- Libros, folletos y otras publicaciones:

Anton, George F., ed. Since the beginning of time; the early history of the College of Agriculture and Mechanic Arts, Mayaguez, College of Agriculture and Mechanic Arts; UPR, 1965, p. 264-314.

Benner, Thomas Eliot. Five years of foundation building; the University of Puerto Rico, 1924 - 1929. Río Piedras, PR, UPR, 1965, p. 157.

Columbic University. Teachers College. International Institute. A survey of the public educational system of Porto Rico. New York, Teachers College, Columbia University, 1926, p. 410-453.

Fernández García, E. El libro de Puerto Rico. The book of Puerto Rico. San Juan, PR, El Libro Azul Publ, 1923, p. 430-433.

B- Artículos de revistas y periódicos:

"Breves apuntes históricos: nuestra Universidad". En: Universidad, Vol. 14, Núm. 126, 12 de marzo de 1959, p. 1,2,7,8.

Colorado, Antonio J. "La Universidad de Puerto Rico razón y misión". En: Norte, Vol. 9, Núm. 9, Octubre 1949, p. 26-29, 72.

"Cómo se fundó la Universidad". En: Universidad, Vol. 5, Núm. 67, 12 de marzo 1953, p.3.

Cruz López, David. "Presupuesto de Universidad ascendía a 20,000 en sus primeros años. Total de 27 personas constituían cuerpo de empleados de institución. Seis profesores boricuas compartían las tareas con norteamericanos. Se ofrecían tres cursos". El Mundo, 9 de marzo de 1953, p. 24.

- "Cuarenta y cinco años". Editorial, El Mundo, 12 de marzo de 1948, p. 6.
- Hernández Aquino, L. "La UPR celebra el 12 aniversario. Cumple 44 años. La Normal de Fajardo fue su inicio. Cuenta ya 6,000 estudiantes". El Mundo, 9 de marzo de 1947, p. 1, 16.
- "Information to Students". En: Summer School News, Año 2, Núm. 2, 1924, p. 11-12.
- "Lucido acto en la Escuela Normal de Río Piedras". En: Puerto Rico Ilustrado, Año 3, Núm. 121, junio 22, 1912, p. 29, foto.
- Massó, Gilda. "Universidad de Puerto Rico; compendio de una historia de treinta años. En: The Puerto Rico School Review, Vol. 16, Núm. 9, mayo 1932, p. 10-14, 36.
- The pioners: W. G. Todd headed the Normal School. En: The UPR Campus Reporter, Vol. 1, Núm. 6, April 18, 1945, p. 3.
- "¿Por qué el 12 de marzo?" En: Universidad, Año 14, Núm. 126, 12 de marzo de 1959, p. 1, 7.
- Puerto Rico University Marks 50th anniversary. En: The IBM Record, Vol. 36, Núm. 13, junio 19, 1953, p. 1-9.
- Ramírez, E. "Calendario histórico. El 12 de marzo de 1903 son las leyes estableciendo la UPR" El Mundo, 12 de marzo de 1957, p. 7.
- Rojas Daporta, Malén. "Puerto Rico hace 50 años; colaborador envía datos sobre la Escuela Normal". El Mundo, 25 de marzo de 1958, p. 26, fotos.
- Rojas Daporta, Malén. "Puerto Rico hace 50 años; Escuela Normal se alojó palacio Convalecencia Río Piedras". El Mundo, 27 de febrero de 1958, p. 32, fotos.
- Selles Solá, Gerardo. "La primera Escuela Normal". En: Revista de la Asociación de Maestros, marzo de 1946, p. 47, 55.
- "Tarea de la Oficina de Planes. Desarrollo y crecimiento de la Universidad de PR". En: Universidad, Vol. 1, Núm. 2, 31 de agosto de 1948, p. 4-5.
- "The UPR" (includes photos del Dr. Benner Chancellor of the UPR) En: Summer School News, Año 4, Núm. 1, July 5-9, 1926, p. 1-2.
- "Un poco de historia". En: Universidad, Vol. 5, Núm. 67, 12 de marzo de 1953, p. 5.

University of Puerto Rico Tower and
Quadrangle
San Juan County
PUERTO RICO

Working No. 6-3-83
Fed. Reg. Date: _____
Date Due: 6/30/83 — 7/18/83

- resubmission
- nomination by person or local government
- owner objection
- appeal

Action: ACCEPT
 RETURN 7/13/83
 REJECT

Federal Agency: _____

Substantive Review: sample request appeal NR decision

Reviewer's comments:

Historically & architecturally significant complex of educational buildings
- however, this nomination must be returned for additional information (see comments below & on reverse)

Recom. / Criteria Return
Reviewer Patrick Andrews
Discipline Historian
Date 7/13/83
 see continuation sheet

Nomination returned for: technical corrections cited below
 substantive reasons discussed below

- 1. Name
- 2. Location
- 3. Classification
Category _____ Ownership _____ Status _____ Present Use _____
Public Acquisition _____ Accessible _____
- 4. Owner of Property
- 5. Location of Legal Description
- 6. Representation in Existing Surveys

has this property been determined eligible? yes no

7. Description

Condition		Check one	Check one
<input type="checkbox"/> excellent	<input type="checkbox"/> deteriorated	<input type="checkbox"/> unaltered	<input type="checkbox"/> original site
<input type="checkbox"/> good	<input type="checkbox"/> ruins	<input type="checkbox"/> altered	<input type="checkbox"/> moved date _____
<input type="checkbox"/> fair	<input type="checkbox"/> unexposed		

Describe the present and original (if known) physical appearance

summary paragraph
 completeness # 4A, 4B, 5, 6, & 11.
 clarity
 alterations/integrity Please provide photos of buildings # 2, 3, 4A, 4B, 5, 6, & 11.
 dates Have any of the buildings been altered since construction - if so, please discuss the nature of the alterations & their effect on the building's historic interior

8. Significance

Period _____ Area of Significance—Check and justify below

Specific dates _____ Builder/Architect _____

Statement of Significance (in one paragraph)

- _____ summary paragraph
- _____ completeness
- _____ clarity
- _____ applicable criteria
- _____ justification of areas checked
- _____ relating significance to the resource
- _____ context
- _____ relationship of integrity to significance
- _____ justification of exception
- _____ other

9. Major Bibliographical References

10. Geographical Data

Acres of nominated property _____

Quadrangle name _____

USIT Reference _____

Please provide a description of the boundary - a site plan can be used if it has the boundary line drawn on it and a measured scale, or a measured description can be provided.

Verbal boundary description and justification _____

the extent of the historic core of the campus? are buildings 5 and 6 part of the original design of the quadrangle?

Please provide a justification for the boundary chosen - is this

11. Form Prepared By

12. State Historic Preservation Officer Certification

The evaluated significance of this property within the state is:

_____ national _____ state _____ local

State Historic Preservation Officer signature _____

Title _____

Date _____

13. Other

- Maps
- Photographs - see comment on reverse.
- _____ Other

Questions concerning this nomination may be directed to Patrick Andrus

Signed Patrick Andrus Date 7/13/83 Phone: 202 272-3504

Comments for any item may be continued on an attached sheet

United States Department of the Interior
National Park Service

For NPS use only

National Register of Historic Places
Inventory—Nomination Form

received APR 6 1984

date entered

See instructions in *How to Complete National Register Forms*
Type all entries—complete applicable sections

1. Name

historic University of Puerto Rico Tower and Quadrangle

and/or common Same

2. Location

street & number Ponce de León Ave. not for publication

city, town Río Piedras vicinity of

state Puerto Rico code 72 county Río Piedras, San Juan code 0930

3. Classification

Category	Ownership	Status	Present Use	
<input type="checkbox"/> district	<input checked="" type="checkbox"/> public	<input checked="" type="checkbox"/> occupied	<input type="checkbox"/> agriculture	<input type="checkbox"/> museum
<input checked="" type="checkbox"/> building(s)	<input type="checkbox"/> private	<input type="checkbox"/> unoccupied	<input type="checkbox"/> commercial	<input checked="" type="checkbox"/> park
<input type="checkbox"/> structure	<input type="checkbox"/> both	<input type="checkbox"/> work in progress	<input checked="" type="checkbox"/> educational	<input type="checkbox"/> private residence
<input type="checkbox"/> site	Public Acquisition	Accessible	<input checked="" type="checkbox"/> entertainment	<input type="checkbox"/> religious
<input type="checkbox"/> object	<input type="checkbox"/> in process	<input type="checkbox"/> yes: restricted	<input checked="" type="checkbox"/> government	<input type="checkbox"/> scientific
	<input type="checkbox"/> being considered	<input checked="" type="checkbox"/> yes: unrestricted	<input type="checkbox"/> industrial	<input type="checkbox"/> transportation
		<input type="checkbox"/> no	<input type="checkbox"/> military	<input type="checkbox"/> other:

4. Owner of Property

name University of Puerto Rico

street & number Ponce de León Ave.

city, town Río Piedras vicinity of state Puerto Rico

5. Location of Legal Description

courthouse, registry of deeds, etc. President's Office and Planning and Development Office

street & number Central Administration and Río Piedras Property Registry

city, town Río Piedras state Puerto Rico

6. Representation in Existing Surveys

title Inventario de Monumentos Históricos has this property been determined eligible? yes no

date 1977 federal state county local

depository for survey records Institute of Puerto Rican Culture

city, town San Juan state Puerto Rico 00905

7. Description

Condition		Check one	Check one
<input type="checkbox"/> excellent	<input type="checkbox"/> deteriorated	<input type="checkbox"/> unaltered	<input checked="" type="checkbox"/> original site
<input checked="" type="checkbox"/> good	<input type="checkbox"/> ruins	<input checked="" type="checkbox"/> altered	<input type="checkbox"/> moved date _____
<input type="checkbox"/> fair	<input type="checkbox"/> unexposed		

Describe the present and original (if known) physical appearance

(See Enclosure No. 1 for a fuller written description; see also accompanying portfolio of photographic illustrations)

The University of Puerto Rico Tower and Quadrangle Complex, which comprises the principal entrance to the Río Piedras Campus, was mainly constructed in the thirties and forties following the design of Arch. Rafael Carmoega. The South side of the Quadrangle was closed in the fifties with two new buildings named Luis Palés Matos and Julia de Burgos (Nos. 4a and 4b) (see date in the Closed Inventory sheet) of simpler design — they lacked the beautiful colored Plateresque decoration which adorned the earlier ones. The same can be said of the latest addition (1983), a three - floor wing, to the Luis Palés Matos building, which runs on the East side closing the last remaining gap of the Quadrangle. The two large buildings included in the nomination and shown within the perimeter of the boundary line in the site plan, Agustín Stahl (No.5) and Julio García Díaz (No. 6), although lying outside the Quadrangle itself, were also built during the original construction with the same design and style, and thus share with it the historic and aesthetic values we wish to preserve in the core of the campus. The newer buildings, notwithstanding the simplicity of their external appearance, blend well with the older, profusely ornamented ones (compare photographs). The whole — Tower with its fronting square, Quadrangle with its inner courtyard extending between the Tower and the Theater, and the two adjacent buildings on the South side — is an unparalleled urban landmark in Puerto Rico.

The exterior of all these buildings has remained unaltered since their construction; the interior remodellings made at various times to accomodate or restructure offices and classrooms have not detracted anything at all from the historic and architectural integrity of the Complex proposed for nomination : great care has been taken to maintain its qualities. Another thing must be noted : several outbuildings whose presence can be noticed in the site plan of the campus are of a temporary nature and will eventually be eliminated, as would also be the building presently housing the Academic Senate, which never was a part of the original plan and stands incongruously behind the Tower.

8. Significance

Period	Areas of Significance—Check and justify below			
<input type="checkbox"/> prehistoric	<input type="checkbox"/> archeology-prehistoric	<input checked="" type="checkbox"/> community planning	<input type="checkbox"/> landscape architecture	<input type="checkbox"/> religion
<input type="checkbox"/> 1400-1499	<input type="checkbox"/> archeology-historic	<input type="checkbox"/> conservation	<input type="checkbox"/> law	<input type="checkbox"/> science
<input type="checkbox"/> 1500-1599	<input type="checkbox"/> agriculture	<input type="checkbox"/> economics	<input type="checkbox"/> literature	<input type="checkbox"/> sculpture
<input type="checkbox"/> 1600-1699	<input checked="" type="checkbox"/> architecture	<input checked="" type="checkbox"/> education	<input type="checkbox"/> military	<input type="checkbox"/> social/
<input type="checkbox"/> 1700-1799	<input type="checkbox"/> art	<input type="checkbox"/> engineering	<input type="checkbox"/> music	<input type="checkbox"/> humanitarian
<input type="checkbox"/> 1800-1899	<input type="checkbox"/> commerce	<input type="checkbox"/> exploration/settlement	<input type="checkbox"/> philosophy	<input type="checkbox"/> theater
<input checked="" type="checkbox"/> 1900-	<input type="checkbox"/> communications	<input type="checkbox"/> industry	<input type="checkbox"/> politics/government	<input type="checkbox"/> transportation
		<input type="checkbox"/> invention		<input type="checkbox"/> other (specify)

Specific dates 1935

Builder/Architect Arch. Rafael Carmoega

Statement of Significance (in one paragraph)

Since it was built in the thirties, the Quadrangle, with its main feature, the tower, has been a landmark in Río Piedras and the whole of the San Juan metropolitan area. From an architectural and aesthetic point of view, it is a unique complex in Puerto Rico -- it has no parallel in style or magnitude and would be worth conserving even if these were its only values. It embodies Hispanic tradition, the principal root of Puerto Rican culture; it is a symbol of the permanent presence of that tradition; and it functions at the same time as a home for unceasing efforts devoted to preserve and extend it. It is the place where higher learning grew to maturity in Puerto Rico, and where indeed it is still epitomized: to speak of "the University" without further specification is to refer to the Río Piedras campus and particularly to its nucleus, the cloisters and buildings that comprise the Quadrangle and contain the Offices of the Chancellor and the central administration of the Campus, the theater where the Casals' Festival used to take place, and the College of Humanities.

As to its historical significance, it must be noted that during the forties and the fifties, the period of Puerto Rico's modernization and its political, social and economic development and coming of age, all public issues were debated in these very halls. Everyone who mattered politically or intellectually was either from the University or had dealings with it. The University was the source of ideas, initiative and plans. That has been its glory. As the state university, it has grown enormously and trained the faculty and staffs of the other, private universities that have appeared and now share in the cultural leadership this campus once enjoyed alone. This particular place merits preservation as a heritage for future generations, for here a significant portion of Puerto Rico's history has been made and its modern leadership has been trained. The University Quadrangle is the symbol of an era.

9. Major Bibliographical References

(See appended list, Enclosure No. 2)

10. Geographical Data

Acreage of nominated property 13.14 acres

Quadrangle name San Juan Quadrangle scale 1:20,000

UTM References Point A: Lat. 18°-24'-17" North, Long. 66°-03'-02" West
 Point B: Lat. 18°-24'-21" North, Long. 66°-02'-55" West
 Point C: Lat. 18°-24'-13" North, Long. 66°-02'-57" West

A	Zone	Easting	Northing	B	Zone	Easting	Northing
C				D			
E				F			
G				H			

Verbal boundary description and justification
 The Quadrangle is located in the western section of the U.P.R., Río Piedras Campus, near the intersection of Ponce de León and Gándara Avenues; it is surrounded by nameless inner streets (see accompanying plans and map, Enclosure No. 3)

List all states and counties for properties overlapping state or county boundaries

state	<u>N/A</u>	code	county	code
state		code	county	code

11. Form Prepared By

name/title Georges Delacre, Ph. D.

organization College of Humanities, U.P.R. date October 24, 1983

street & number Río Piedras Campus, U.P.R. telephone 764-0000 Ext. 2442, 2466

city or town Río Piedras state Puerto Rico

12. State Historic Preservation Officer Certification

The evaluated significance of this property within the state is:
 national state local

As the designated State Historic Preservation Officer for the National Historic Preservation Act of 1966 (Public Law 89-665), I hereby nominate this property for inclusion in the National Register and certify that it has been evaluated according to the criteria and procedures set forth by the National Park Service.

State Historic Preservation Officer signature *Sebrín de los Angeles*
 title State Historic Preservation Officer date March 14, 1984

For HCERS use only
 I hereby certify that this property is included in the National Register

George A. Vozzo date 5/17/84
 Keeper of the National Register

Attest: _____ date _____
 Chief of Registration

I N D E X

	PAGES
HISTORICAL BACKGROUND	1 - 4
INVENTORY OF BUILDINGS	6
PHOTOGRAPHS	8

TOWER AND QUADRANGLE COMPLEX, CENTRAL CAMPUS,
UNIVERSITY OF PUERTO RICO, RIO PIEDRAS, PUERTO RICO
(1935 -)

By Dr. Eugene E. Crommett
Professor of Architecture, UPR

HISTORICAL BACKGROUND:

Founded in 1903 with 90 students and 12 professors, the University of Puerto Rico is today (1982) an Island-wide university system with a student population in the tens of thousands. What is at present its main campus in Río Piedras consists of 128 buildings occupying 280 acres of park-like ground on the edge of Metropolitan San Juan. The Tower and Quadrangle Complex, dating from 1935, comprises the main and "official" entrance to the campus, the Tower, administrative offices, classroom buildings, and the University Theater.

Although the campus has long since expanded well beyond the limits of its original buildings, the Complex with its urban landmark tower, distinctive appearance and organization, and integration of buildings with the natural landscape, remains the gateway, core and symbol of the entire campus, indeed of the university system as a whole.

THE ARCHITECTS:

The architect for the Complex was the well known Rafael Carmo-
ega who designated several other architects to assist him: William
Shimmelpfening, a German-American who planned the Tower, and Puerto

Rican architects Francisco Gardón who designed the Theater, Rafael Hernández, Eloy Plard, and Raúl Reichard. Until his untimely death, the architect Pedro de Castro was contractor for the project. This group was responsible for the design of the project in all its details, including the structural and other building systems.

URBAN SETTING:

The Tower and Quadrangle Complex acts as a transitional element between the urban area surrounding it and the park-like environment of the campus. Three gates along Ponce de León Avenue open onto a large, well landscaped fore area: the center entrance, for pedestrians, is on the central axis of the whole Complex which moves up a palm-lined walkway, through the center of the Tower and out into the inner cloister area, to end at the entrance of the University Theater (a later building unfortunately interrupts this axis); the two outer vehicle entrances are at the ends of a loop road which approaches the Tower at its center, where pedestrians meet to enter the Complex. The distinctive bell-observation Tower has long been a focal and orientation point for the university and the surrounding urban area.

ARCHITECTURAL ORGANIZATION OF THE COMPLEX:

The buildings of the Complex are arranged to accommodate three organizational concepts: a main symmetrical axis from the main entrance to the Theater; a traditional cloister or inner quadrangle around which the buildings are sited and onto which they open; and a series of arcades which offer sheltered communications and exits at the corners of the Quadrangle.

The inner garden plaza facilitates diagonal pedestrian traffic through the Quadrangle, and serves as an open but tree-shaded place for rest and conversation.

NOTES ON MATERIALS AND CONSTRUCTION:

Except, perhaps, for the Tower and the University Theater, the materials and methods of construction of the buildings of the Complex are conventional, but they are well executed. Moreover, their consistency of use and quality gives additional unity to the Quadrangle.

The buildings are two and three stories in height and rectangular in shape. Class and other rooms are generally arranged along single loaded corridors (arcades) for the most part, facilitating cross ventilation, although the registrar's office building has double loaded corridors. The rectangular units are connected into H-forms, keeping the plan open, well ventilated, and affording contact between the interiors and the landscaped grounds outside. The general layout of the buildings is an early and viable solution for solar design in the humid tropics.

The materials of construction are masonry concrete, stucco, wood, and tiles. Sloping roof sections carry Spanish red clay tiles, giving drainage, character and continuity, especially to the arcades. The Tower entrance, with its high vaulted ceiling and inner balcony under it, combines structural wood construction with concrete masonry. The University Theater (long known as the home of the Casals Festival) employs modern structural techniques with its long trusses over the audience, and its mechanical and electrical systems, and has seats for nearly 2500. Wall surfaces are smooth

(except for the concentrations of decorative elements) and finished in plaster and paint.

STYLE AND DECORATION :

The Tower and Quadrangle Complex derives much of its importance from its overall organizational themes and unity, as well as its strong character as an urban landmark. But it is also significant as an example of Puerto Rican architects searching for and creating an appropriate symbol for a modern university in Puerto Rico located at the meeting place of North and South America, and of past and present cultures. The contrasts between simplicity and complexity and the historical allusions to the Spanish Colonial Renaissance or Baroque, that is the Plateresque Style, seemed appropriate to them.

Stylistically, the Complex is an adapted, modified Plateresque, say Neo-Plateresque, which depends heavily upon sometimes dramatic contrasts between simple stark surfaces and elaborated concentrations of ornament at fenestration elements. Thus in the Complex's arcades there are twisted columns capped by Corinthian capitals, and concentrations of ornaments reminiscent of Spanish Baroque altar pieces appear in the interior of the University Theater. Heraldic shields, figures, faces, foliage, pilasters, volutes, and cornices are brought together and brightly colored in concentrations that mark principal entrances, notably that of the Tower.

The main portal of the Tower - and the Quadrangle - provides the best example of this Neo-Plateresque ornamentation, and as well of

the symbolic intent of the project's designers. That the University of Puerto Rico is firmly planted in the soil once occupied by the Conquistadores is evident from the portal's Plateresque (Plateresco, Sp.) roots. But more significantly, there are three large heraldic shields directly over and forming the main motif of the decorative concentration at this entrance. At the center, significantly, the shield depicts the precepts of history, of knowledge and of work. The shield at the left, representing the Americas of the South, is of the University of San Marcos in Perú, and that at the right, representing the Americas of the North, is of the University of Harvard. Similarly, embedded in the floor of the Tower entrance under the vaulted ceiling is a circle of plaque-shields representing the countries of North, Central and South America.

INVENTORY OF BUILDINGS

I N V E N T O R Y

QUADRANGLE:

Name of the buildings that compose the Quadrangle and other contiguous buildings.

1. The Tower - (1937 (1st floor: Román Baldorioty de Castro)
(2nd floor: Franklin Delano Roosevelt)
2. Antonio S. Pedreira (1937)
3. Sebastián González García (1944)
4. Luis Palés Matos and Julia de Burgos Amphitheater
5. Agustín Stahl (contiguous to the Quadrangle)
6. Julio García Díaz (contiguous to the Quadrangle)
7. Theater (no name) (1935-40)
8. Eugenio María de Hostos (1935-40)
9. Registrar's Office (1935)
10. Felipe Janer (1927)
11. Janer B Annex (Home Economics)

Source: Juan José González Correa
Central Archives' Director

PHOTOGRAPHS

BIBLIOGRAFIA

A- Libros, folletos y otras publicaciones:

Anton, George F., ed. Since the beginning of time; the early history of the College of Agriculture and Mechanic Arts, Mayaguez, College of Agriculture and Mechanic Arts; UPR, 1965, p. 264-314.

Benner, Thomas Eliot. Five years of foundation building; the University of Puerto Rico, 1924 - 1929. Río Piedras, PR, UPR, 1965, p. 157.

Columbic University. Teachers College. International Institute. A survey of the public educational system of Porto Rico. New York, Teachers College, Columbia University, 1926, p. 410-453.

Fernández García, E. El libro de Puerto Rico. The book of Puerto Rico. San Juan, PR, El Libro Azul Publ, 1923, p. 430-433.

B- Artículos de revistas y periódicos:

"Breves apuntes históricos: nuestra Universidad". En: Universidad, Vol. 14, Núm. 126, 12 de marzo de 1959, p. 1,2,7,8.

Colorado, Antonio J. "La Universidad de Puerto Rico razón y misión". En: Norte, Vol. 9, Núm. 9, Octubre 1949, p. 26-29, 72.

"Cómo se fundó la Universidad". En: Universidad, Vol. 5, Núm. 67, 12 de marzo 1953, p.3.

Cruz López, David. "Presupuesto de Universidad ascendía a 20,000 en sus primeros años. Total de 27 personas constituían cuerpo de empleados de institución. Seis profesores boricuas compartían las tareas con norteamericanos. Se ofrecían tres cursos". El Mundo, 9 de marzo de 1953, p. 24.

- "Cuarenta y cinco años". Editorial, El Mundo, 12 de marzo de 1948, p. 6.
- Hernández Aquino, L. "La UPR celebra el 12 aniversario. Cumple 44 años. La Normal de Fajardo fue su inicio. Cuenta ya 6,000 estudiantes". El Mundo, 9 de marzo de 1947, p. 1, 16.
- "Information to Students". En: Summer School News, Año 2, Núm. 2, 1924, p. 11-12.
- "Lucido acto en la Escuela Normal de Río Piedras". En: Puerto Rico Ilustrado, Año 3, Núm. 121, junio 22, 1912, p. 29, foto.
- Massó, Gilda. "Universidad de Puerto Rico; compendio de una historia de treinta años. En: The Puerto Rico School Review, Vol. 16, Núm. 9, mayo 1932, p. 10-14, 36.
- The pioners: W. G. Todd headed the Normal School. En: The UPR Campus Reporter, Vol. 1, Núm. 6, April 18, 1945, p. 3.
- "¿Por qué el 12 de marzo?" En: Universidad, Año 14, Núm. 126, 12 de marzo de 1959, p. 1, 7.
- Puerto Rico University Marks 50th anniversary. En: The IBM Record, Vol. 36, Núm. 13, junio 19, 1953, p. 1-9.
- Ramírez, E. "Calendario histórico. El 12 de marzo de 1903 son las leyes estableciendo la UPR" El Mundo, 12 de marzo de 1957, p. 7.
- Rojas Daporta, Malén. "Puerto Rico hace 50 años; colaborador envía datos sobre la Escuela Normal". El Mundo, 25 de marzo de 1958, p. 26, fotos.
- Rojas Daporta, Malén. "Puerto Rico hace 50 años; Escuela Normal se alojó palacio Convalecencia Río Piedras". El Mundo, 27 de febrero de 1958, p. 32, fotos.
- Selles Solá, Gerardo. "La primera Escuela Normal". En: Revista de la Asociación de Maestros, marzo de 1946, p. 47, 55.
- "Tarea de la Oficina de Planes. Desarrollo y crecimiento de la Universidad de PR". En: Universidad, Vol. 1, Núm. 2, 31 de agosto de 1948, p. 4-5.
- "The UPR" (includes photos del Dr. Benner Chancellor of the UPR) En: Summer School News, Año 4, Núm. 1, July 5-9, 1926, p. 1-2.
- "Un poco de historia". En: Universidad, Vol. 5, Núm. 67, 12 de marzo de 1953, p. 5.

NATIONAL REGISTER OF HISTORIC PLACES
EVALUATION/RETURN SHEET

University of Puerto Rico Tower and
Quadrangle
San Juan County
PUERTO RICO

Substantive Review

Working No. 6-3-83
Fed. Reg. Date: 2-5-85
Date Due: 5/21/84
Action: ACCEPT 5-17-84
 RETURN
 REJECT
Federal Agency: _____

- resubmission
- nomination by person or local government
- owner objection
- appeal

Substantive Review: sample request appeal NR decision

Reviewer's comments: This district comprises the historic core of the University of Puerto Rico. Earliest building is 1927, but the majority date to 30's + 40's when the University + its faculty played a critical role in the political + intellectual life
Rec'd Com. Criteria ACCEPT A, C
Reviewer DUBIE
Discipline HIST.
Date 5/15/84
_____ see continuation sheet

Nomination returned for: technical corrections cited below
 substantive reasons discussed below

of the emerging, modern Commonwealth. Exeptional importance not specifically discussed but clearly present. Supporting architecture value as very strong collection of Spanish/Mediterranean Revival institutional buildings.

1. Name

2. Location

3. Classification

Category Ownership Status Present Use
 Public Acquisition Accessible

4. Owner of Property

5. Location of Legal Description

6. Representation in Existing Surveys

Has this property been determined eligible? yes no

7. Description

Condition excellent good fair deteriorated ruins unexposed unaltered altered original site moved date _____

Describe the present and original (if known) physical appearance

- summary paragraph
- completeness
- clarity
- alterations/integrity
- dates
- boundary selection

dates of construction provided for all buildings
additional photos provided.

8. Significance

Period _____ Areas of Significance—Check and justify below

Specific dates _____ Builder/Architect _____

Statement of Significance *(in one paragraph)*

- summary paragraph
- completeness
- clarity
- applicable criteria
- justification of areas checked
- relating significance to the resource
- context
- relationship of integrity to significance
- justification of exception
- other

9. Major Bibliographical References

10. Geographical Data

Acreeage of nominated property _____
 Quadrangle name _____
 UTM References _____

boundary described + justified

Verbal boundary description and justification

11. Form Prepared By

12. State Historic Preservation Officer Certification

The evaluated significance of this property within the state is:

____ national ____ state ____ local

State Historic Preservation Officer signature

title _____ date _____

13. Other

- Maps
- Photographs
- Other

photos provided

Questions concerning this nomination may be directed to _____

Signed _____ Date _____ Phone: _____

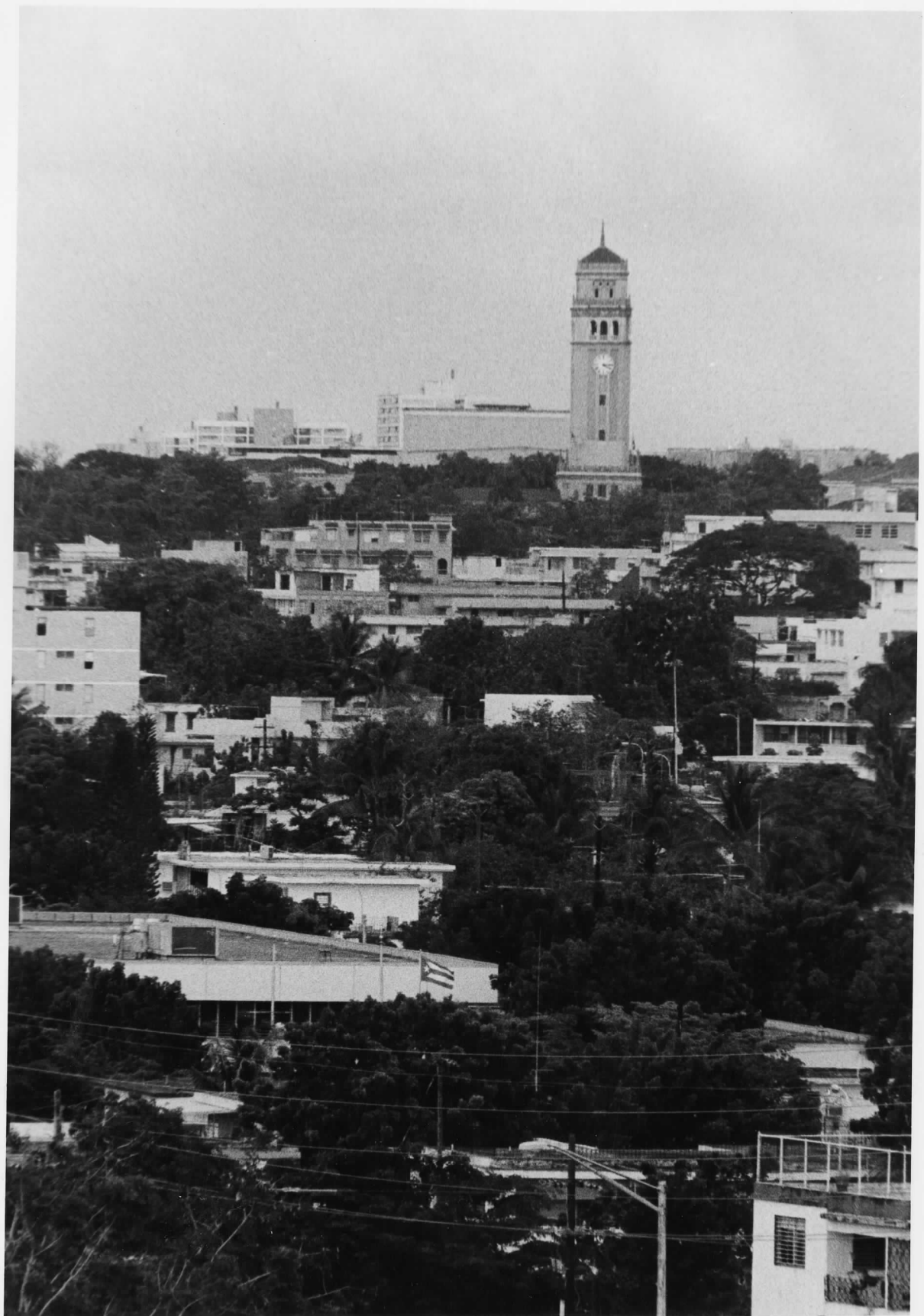







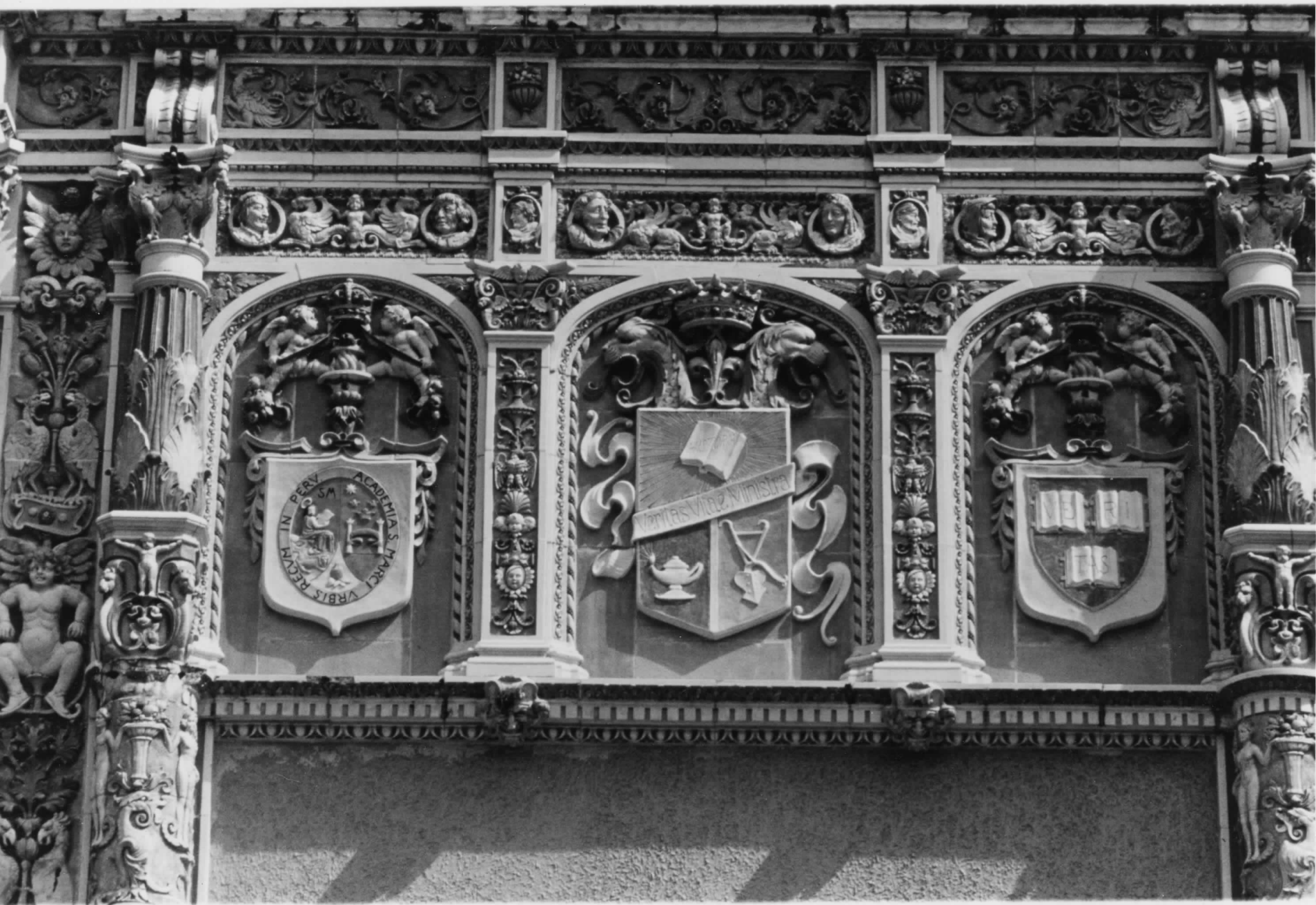























En profunda actitud de respeto
a la verdad creadora y a la duda
creadora

La Universidad ha de enseñar a
enseñar y enseñar a aprender

LEY DE LA UNIVERSIDAD
PORTO RICO
7 DE MAYO DE 1942



UNIVERSIDAD DE PUERTO RICO

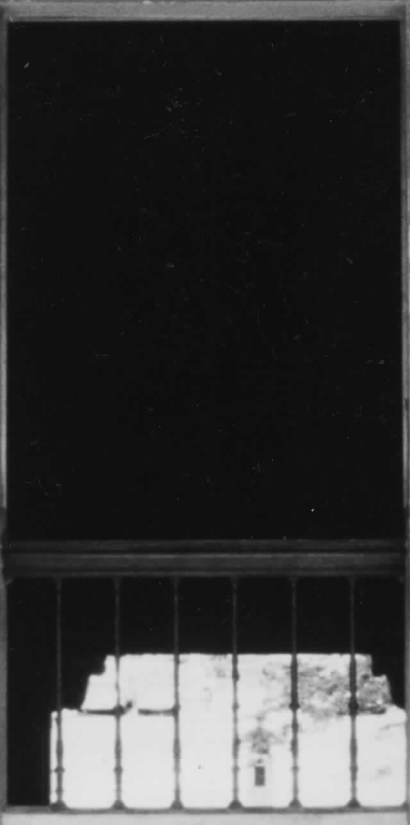























































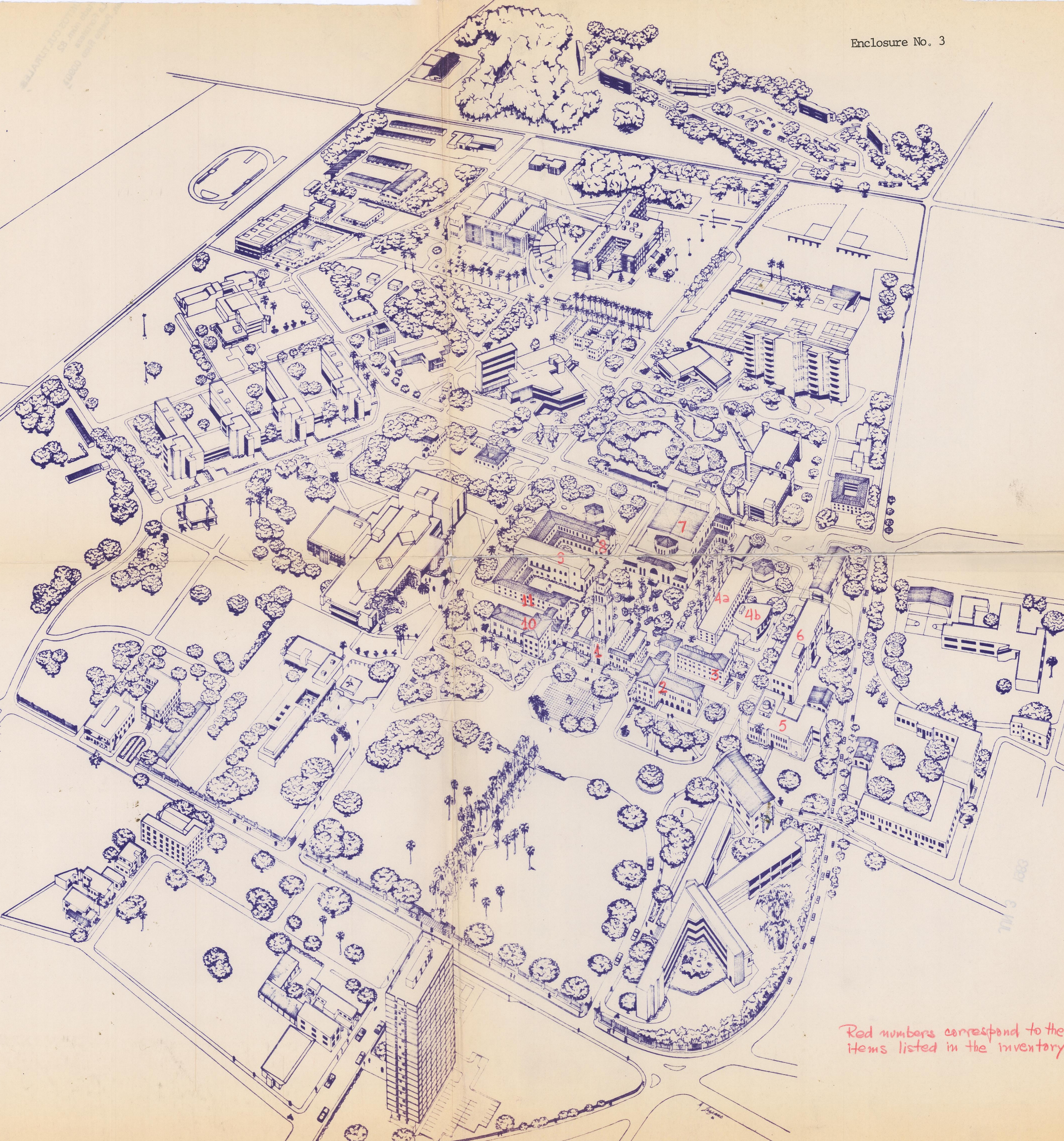

Red numbers 1 through 11 are placed on various buildings in the central part of the campus plan.

Red numbers correspond to the items listed in the inventory

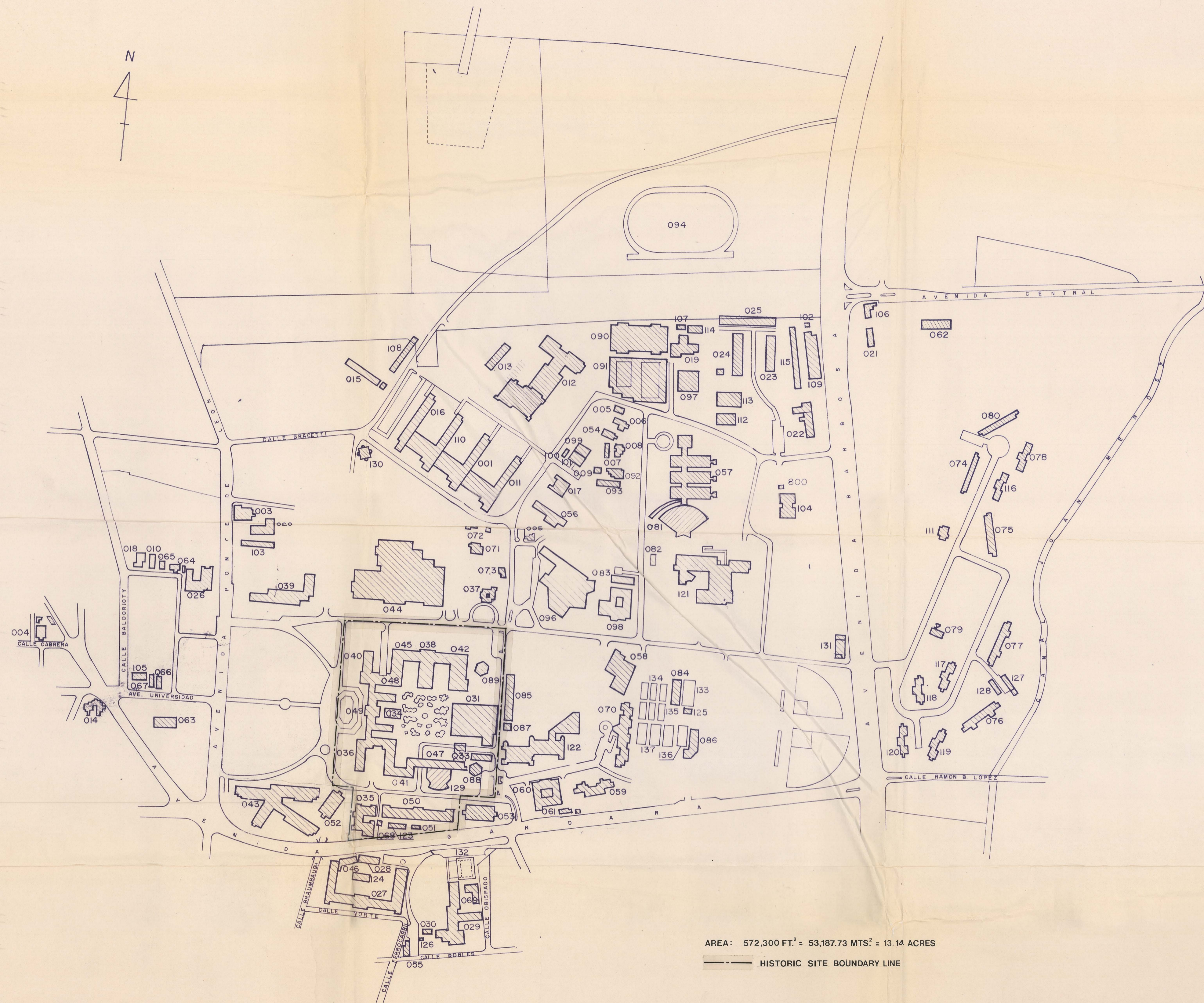

ABREV.	NUM.	EDIFICIO	ABREV.	NUM.	EDIFICIO
C	001	ADMINISTRACION COMERCIAL	RU-5	066	BELLOS OFICIOS
CB	002	CASETA DE BAILE (DESTRUIDA)	BO	067	BELLOS OFICIOS
M	003	MONSERRATE	AST	068	ANEXO AGUSTIN STAHL
ET	004	TURABO	EE-1	069	CAFETERIA ESCUELA ELEMENTAL
PLN-1	005	ESCUELA DE PLANIFICACION	RS	070	RESIDENCIA DE SEÑORITAS
PLN-2	006	ESCUELA DE PLANIFICACION	RR	071	RESIDENCIA DEL RECTOR
PLN-3	007	ESCUELA DE PLANIFICACION	RR-1	072	CASA SERVICIO RES. RECTOR
PLN-4	008	ESCUELA DE PLANIFICACION	RH	073	RESIDENCIA PARA HUESPEDES
PLN-5	009	ESCUELA DE PLANIFICACION	RF-1	074	RESIDENCIA DE LA FACULTAD
PG	010	ESCUELA GRADUADA DE PEDAGOGIA	RF-2	075	RESIDENCIA DE LA FACULTAD
O	011	JUAN JOSE OSUNA	RF-3	076	RESIDENCIA DE LA FACULTAD
L	012	ESCUELA DE DERECHO	RF-4	077	RESIDENCIA DE LA FACULTAD
AL	013	CLINICA DE ASISTENCIA LEGAL	RF-5	078	RESIDENCIA DE LA FACULTAD
EPR	014	EDIFICIO PUERTO RICO	RF-6	079	RESIDENCIA DE LA FACULTAD
AS	015	ALMACEN DE SUMINISTROS	RF-7	080	RESIDENCIA DE LA FACULTAD
CSG	016	CIENCIAS SOCIALES GRADUADO	AEG	081	ANFITEATRO ESTUDIOS GENERALES
AA	017	PLANTA AIRE ACONDICIONADO CENTRAL	MEG	082	MERENDERO ESTUDIOS GENERALES
EGAE	018	COMERCIO GRADUADO	EF	083	ANEXO CENTRO DE COMPUTOS
IRT	019	INSTITUTO RELACIONES DEL TRABAJO	EF-1	084	OFICINAS Y SALONES DEBAJO DE LAS GRADAS
HM	020	HOGAR MASONICO	AC	085	ARCHIVO CENTRAL
TB	021	TALLER DE BELLAS ARTES	AS	086	ALMACEN DE SUMINISTROS
TE	022	DEPARTAMENTO TERRENOS Y EDIFICIOS	OAC	087	FACULTAD HUMANIDADES DEPT. DRAMA
TE-1	023	TALLERES TERRENOS Y EDIFICIOS 1	GV	088	GLORIETA VEVE (MERENDERO)
TE-2	024	TALLERES TERRENOS Y EDIFICIOS 2	GLO	089	GLORIETA FABIAN
TE-3	025	TALLERES TERRENOS Y EDIFICIOS 3	GN	090	GIMNASIO NUEVO
CS	026	BEATRIZ LASALLE (TRABAJO SOCIAL)	PS	091	PISCINAS
ES	027	ESCUELA SUPERIOR	BAI	092	BELLAS ARTES 1
AES	028	ANFITEATRO Y ANEXO ESCUELA SUPERIOR	BA2	093	BELLAS ARTES 2
EE	029	ESCUELA ELEMENTAL	PA	094	PISTA ATLETICA
CEE	030	MERENDERO ESCUELA ELEMENTAL	CI	095	CORREO INTERIOR
7-T	031	TEATRO	CU	096	CENTRO UNIVERSITARIO
ST-1	032	SALONES TEMPOREROS (DESTRUIDOS)	CF	097	CENTRO DE LA FACULTAD
ST-2	033	OFICINAS ADMINISTRATIVAS (VARIAS)	CC	098	CENTRO DE COMPUTOS
SA	034	SENADO ACADEMICO	SE	099	SUBESTACION ELECTRICA
5-S	035	AGUSTIN STAHL	CCONT	100	CUARTO CONTROLES ELECTRICOS
2-P	036	ANTONIO S. PEDREIRA	SECD	101	CUARTO DISTRIBUCION SUBESTACION
	037		EG	102	ESTACION DE GASOLINA
9-OR	038	OFICINA DEL REGISTRADOR	CE	103	OFIC. ADMINISTRATIVAS (TEMPORERAS)
M	039	MUSEO	G	104	TRANSITO Y VIGILANCIA
10-J	040	FELIPE JANER	I	105	DIVISION DE IMPRESOS
3-SGG	041	SEBASTIAN GONZALEZ GARCIA	EP	106	ALMACEN
8-HO	042	EUGENIO M. DE HOSTOS	CP	107	CASETA DE SERVICIO A PISTA
FB	043	FACUNDO BUESO	CST	108	COMPRAS Y SUMINISTROS
BG	044	BIBLIOTECA GENERAL JOSE M. LAZARO	AS	109	ALMACEN CENTRAL DE SUMINISTROS
11-AED	045	ANEXO ECONOMIA DOMESTICA	REB	110	COLEGIO CIENCIAS SOCIALES
AES	046	ANEXO ESCUELA SUPERIOR	RF-8	111	RESIDENCIA DE LA FACULTAD
4a-LPM	047	LUIS PALES MATOS	TAI-1	112	TALLER DE ARTES INDUSTRIALES 1
11-ED	048	ECONOMIA DOMESTICA	TAI-2	113	TALLER DE ARTES INDUSTRIALES 2
1-BT	049	BALDORIOTY	TAI-3	114	TALLER DE ARTES INDUSTRIALES 3
6-B	050	JULIO GARCIA DIAZ	AS	115	ALMACEN DE SUMINISTROS
B-1	051	ANEXO	RF-9	116	RESIDENCIA DE LA FACULTAD
AFB	052	FACILIDADES TEMPORERAS	RF-10	117	RESIDENCIA DE LA FACULTAD
AP	053	FACILIDADES TEMPORERAS	RF-11	118	RESIDENCIA DE LA FACULTAD
AL	054	CLINICA DE ASISTENCIA LEGAL	RF-12	119	RESIDENCIA DE LA FACULTAD
CPUB	055	ESCUELA DE COMUNICACION PUBLICA	RF-13	120	RESIDENCIA DE LA FACULTAD
SM	056	SERVICIOS MEDICOS	CNN	121	CIENCIAS NATURALES NUEVO
NEG	057	ESTUDIOS GENERALES	PN	122	PEDAGOGIA NUEVO
ARQ	058	ESCUELA DE ARQUITECTURA	AUGD	123	ANEXO JULIO GARCIA DIAZ
EDP	059	FACILIDADES ECONOMICAS	CES	124	CAFETERIA ESCUELA SUPERIOR
DE	060	DECANATO DE ESTUDIANTES	A	125	ALMACEN DE PROPIEDAD
DE-1	061	ANEXO DECANATO DE ESTUDIANTES	GCES	126	ALMACEN
DM	062	DEPARTAMENTO MILITAR	GRF	127	GARAGES RESIDENCIAS DE LA FACULTAD
DV	063	DORMITORIO DE VARONES	GRF	128	GARAGES RESIDENCIAS DE LA FACULTAD
RU-3	064	OFICINA DE ADMISIONES	4b-JDB	129	JULIA DE BURGOS
RU-4	065	ALMACEN ARCHIVO CENTRAL	MCS	130	MERENDEROS
HUER	800	HUERTO (LABORATORIO ECONOMIA DOMESTICA)	CIST	131	CISTERNA
			CESUP	132	CANCHA ESCUELA SUPERIOR
			CT	133	CANCHA DE TENIS
			CT-1	134	CANCHAS DE TENIS
			CT-2	135	CANCHAS DE TENIS
			CB	136	CANCHA DE BALONCESTO
			CB-1	137	CANCHAS DE BALONCESTO

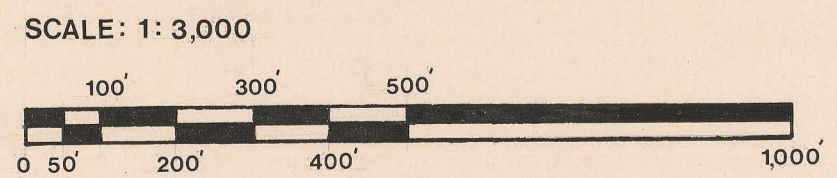

AREA: 572,300 FT.² = 53,187.73 MTS.² = 13.14 ACRES
 --- HISTORIC SITE BOUNDARY LINE

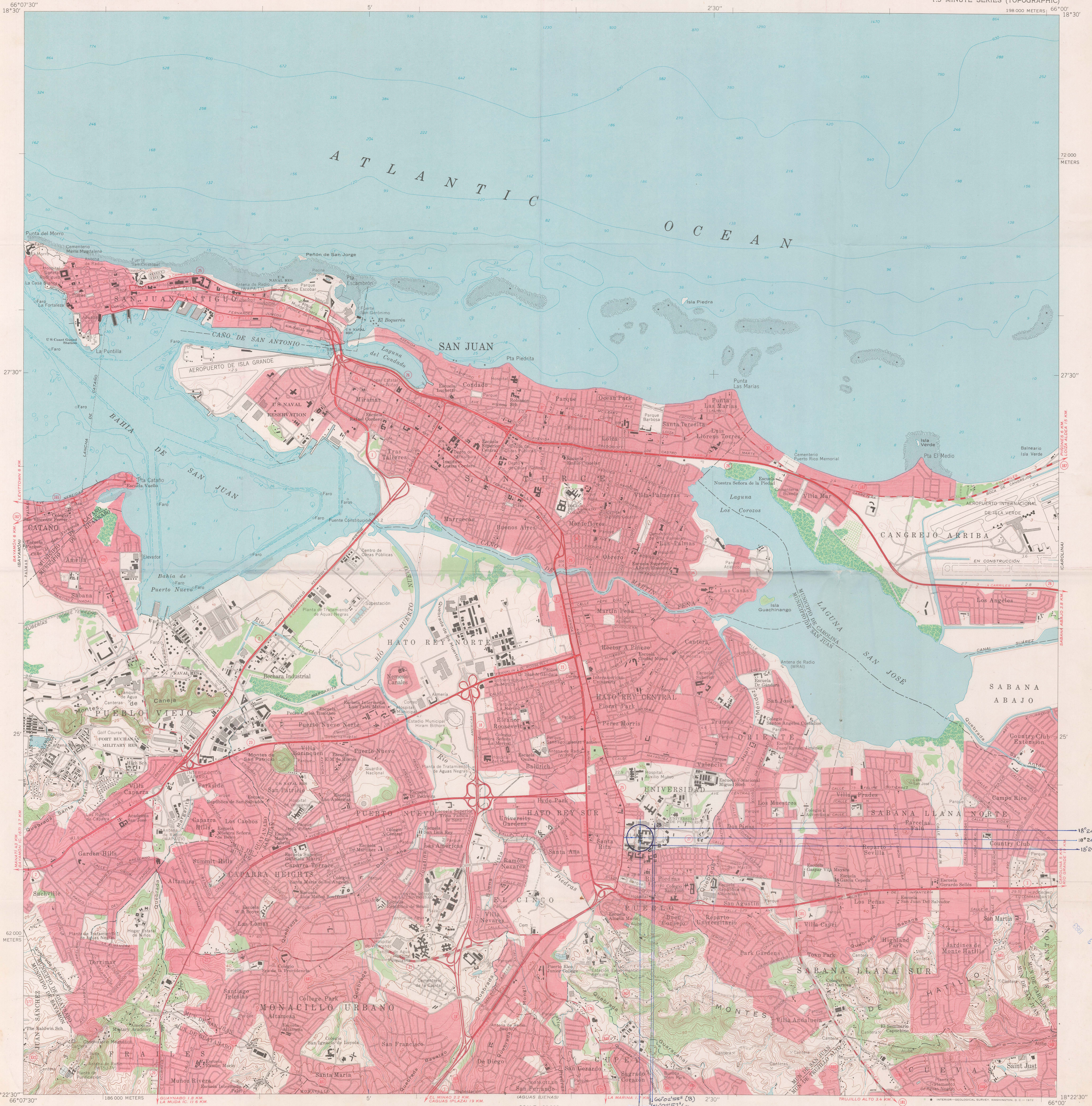

Mapped, edited, and published by the Geological Survey
Control by USGS and USC&GS

Topography by photogrammetric methods from aerial photographs
taken 1962. Field checked 1963. Revised from aerial
photographs taken 1967. Field checked 1969.

Selected hydrographic data compiled from USGS Charts 903 (1964) and
908 (1965). This information is not intended for navigational purposes.

Polycyclic projection. Puerto Rico datum, 1940 adjustment
2000-meter grid based on Puerto Rico coordinate system.

Barrio and municipality boundaries by the Puerto Rico Planning Board.
Red tint indicates areas in which only landmark buildings are shown.

APPROXIMATE MEAN
DECLINATION, 1969

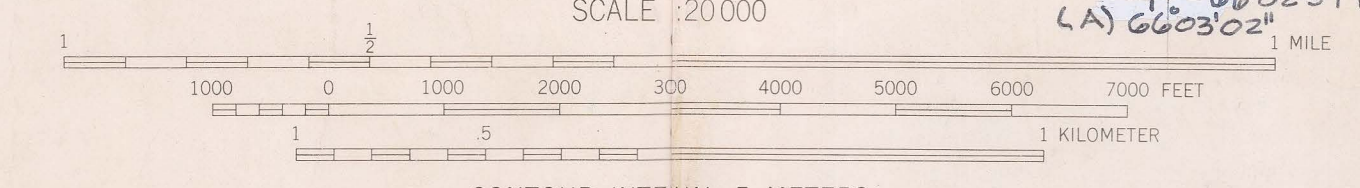

CONTOUR INTERVAL 5 METERS
DOTTED LINES REPRESENT 1-METER CONTOURS
DATUM IS MEAN SEA LEVEL
DEPTH CURVES AND SOUNDINGS INFLECT—DATUM IS MEAN LOW WATER
SHORELINE SHOWN REPRESENTS THE APPROXIMATE LINE OF MEAN HIGH WATER
THE MEAN RANGE OF TIDE IS APPROXIMATELY 0.3 METERS

THIS MAP COMPLIES WITH NATIONAL MAP ACCURACY STANDARDS
FOR SALE BY U. S. GEOLOGICAL SURVEY, WASHINGTON, D. C. 20242
AND DEPARTMENT OF PUBLIC WORKS, SAN JUAN, PUERTO RICO 00910
A FOLDER DESCRIBING TOPOGRAPHIC MAPS AND SYMBOLS IS AVAILABLE ON REQUEST

PUERTO RICO

QUADRANGLE LOCATION

ROAD CLASSIFICATION
Primary highway, all weather. Light-duty road, all weather,
hard surface. Improved surface.
Secondary highway, all weather. Unimproved road, fair or dry
hard surface. weather.
Insular Route

SAN JUAN, P. R.
N1822.5-W6600/7.5

OFFICE OF THE GOVERNOR
LA FORTALEZA
SAN JUAN, PUERTO RICO 00901



STATE HISTORIC PRESERVATION OFFICE

May 26, 1983

Ms. Carol Shull
Chief of Registration
National Register of Historic Places
National Park Service
Department of the Interior
Washington, D.C. 20240

Dear Ms. Shull:

Enclosed is the nomination form for the University of Puerto Rico Tower and Quadrangle Complex, located in Río Piedras, Puerto Rico.

We will appreciate the expeditious review of this nomination by the National Register staff.

Cordially yours,

Arleen Pabón de Rocafort, PhD.
State Historic Preservation Officer

nr

Enclosure

OFFICE OF THE GOVERNOR
LA FORTALEZA
SAN JUAN, PUERTO RICO 00901



STATE HISTORIC PRESERVATION OFFICE

March 29, 1984.

Ms. Carol Shull
Chief of Registration
National Register of Historic Places
National Park Service
Department of the Interior
Washington, D.C. 20240

Dear Ms. Shull:

Enclosed is the Nomination Form for the University of Puerto Rico Tower and Quadrangle Complex, located in Río Piedras, Puerto Rico. This nomination was returned to our office for technical corrections.

Following your staff recommendations, Item No. 7, Description has been rewritten; an inventory of all buildings included in the nomination with its construction dates has been added (see enclosure no. 1); photographs of all buildings in the nomination have been included and finally; a site plan of the quadrangle with its scale and acreage have been added.

We hope this information complies with all National Register requirements and request that your staff expedite the review of this resubmitted form.

Cordially yours,

A handwritten signature in cursive script, reading "Arleen Pabón de Rocafort".

Arleen Pabón de Rocafort, Phd.
State Historic Preservation Officer